

Unitarian Universalist Church of Nashua

November 2022
Building Our Vision
Plan Options

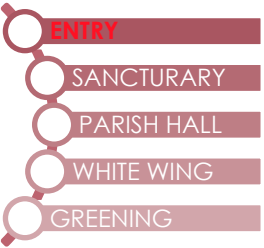



Building Our Vision Options

- **Core Plan**
- **Welcoming Plan**
 - Includes all Core Plan items
- **Visionary Plan**
 - Includes all Core & Welcoming Plan items



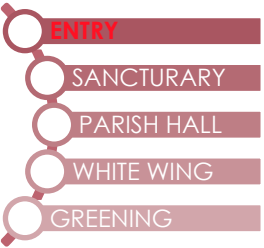

Building Our Vision Core Plan

- New efficient Gas Boilers for Sanctuary and Parish House
- Insulation in the walls and attic of the Sanctuary & Parish House
- Add large glass panels on the inside of the Sanctuary windows to make them more energy efficient
- Insulation and glass will help quiet the outside road noise from the road



Core Plan

- **Sanctuary and Parish House**
 - Both have almost no insulation
 - Infrared studies show significant heat loss in walls, ceilings, and windows
 - We wish to be good stewards of the earth
 - Significant cost savings
 - Improved comfort

- **Core Plan Improves the Building Envelope**

- Insulation
- Windows
- Air tightness

- **Improves Energy Efficiency**

- Replace the existing old HVAC systems In Sanctuary and Parish House
- Upgrade old unreliable gas boilers to modern energy efficient models

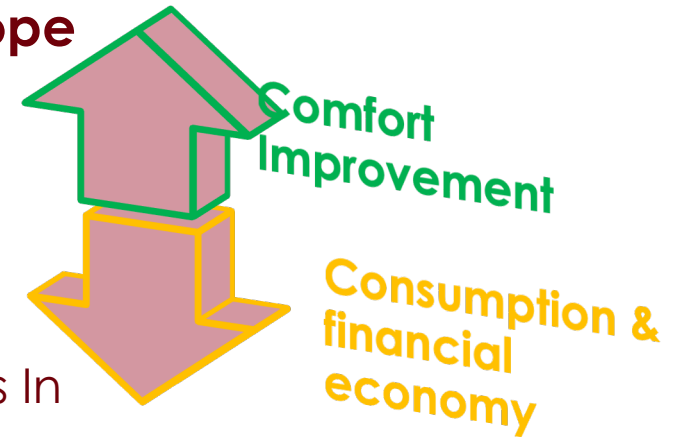

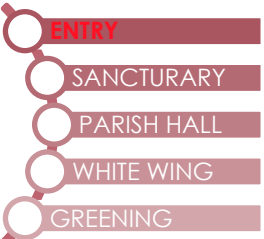

Building Our Vision Welcoming Plan

- New Main Entry to the church that is ADA accessible
- Expanded Narthex
- **Plus Core Plan Features**
 - New efficient Gas Boilers for Sanctuary and Parish House
 - Insulation in the walls and attic of the Sanctuary & Parish House
 - Add large glass panels on the inside of the Sanctuary windows to make them more energy efficient



Welcoming Plan Overview

- **Accessibility** – easy access for the entire range of mobility
- **Path finding / Circulation**
Provide a single entrance, and help visitors find their way intuitively on the campus
- Present a **unified** and **coherent** face to the world, while preserving the identity and history of each building of the campus
- Mitigate the image of a **fortress** atop an inaccessible mountain



Welcoming Plan External View

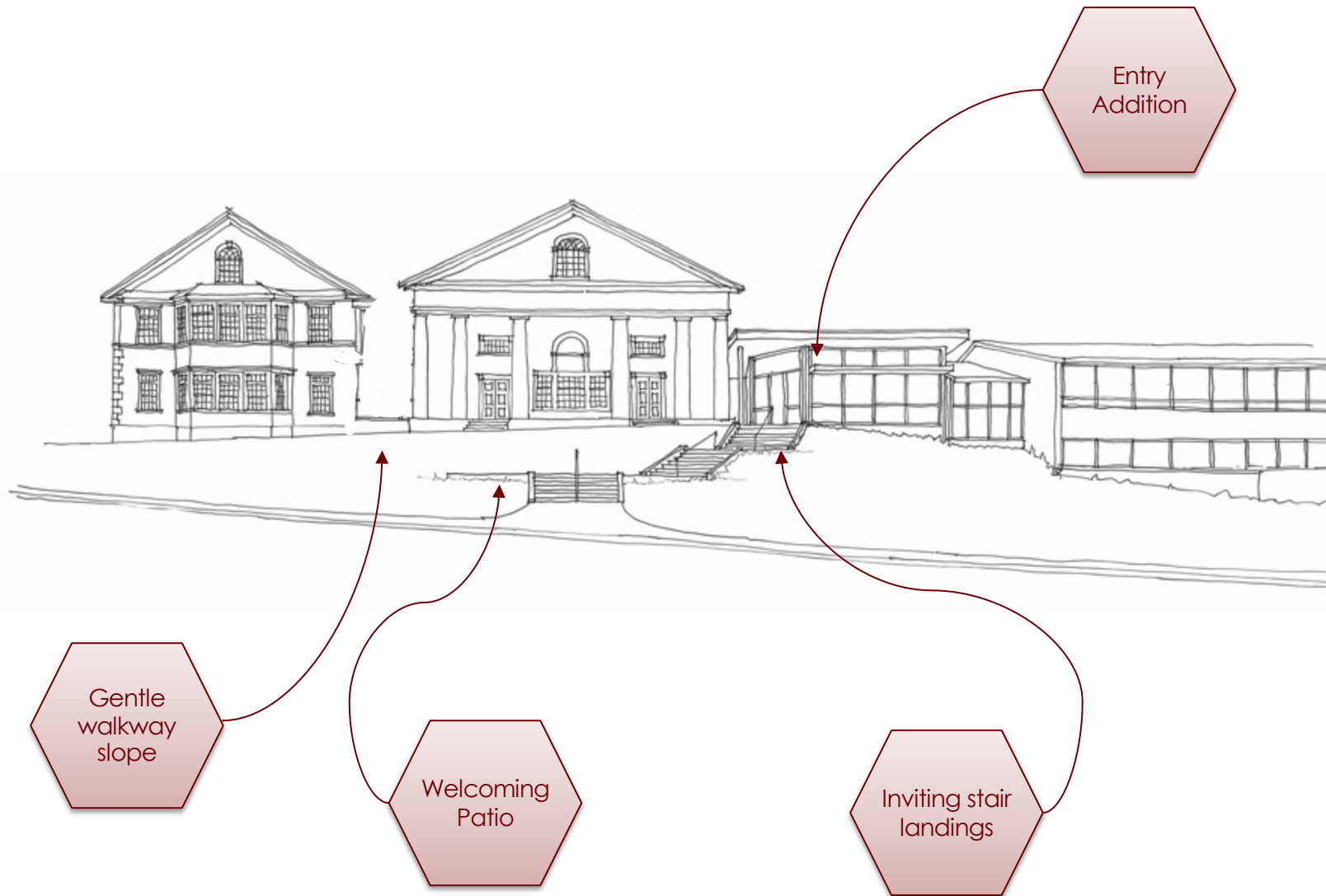

Welcoming Plan Aerial View

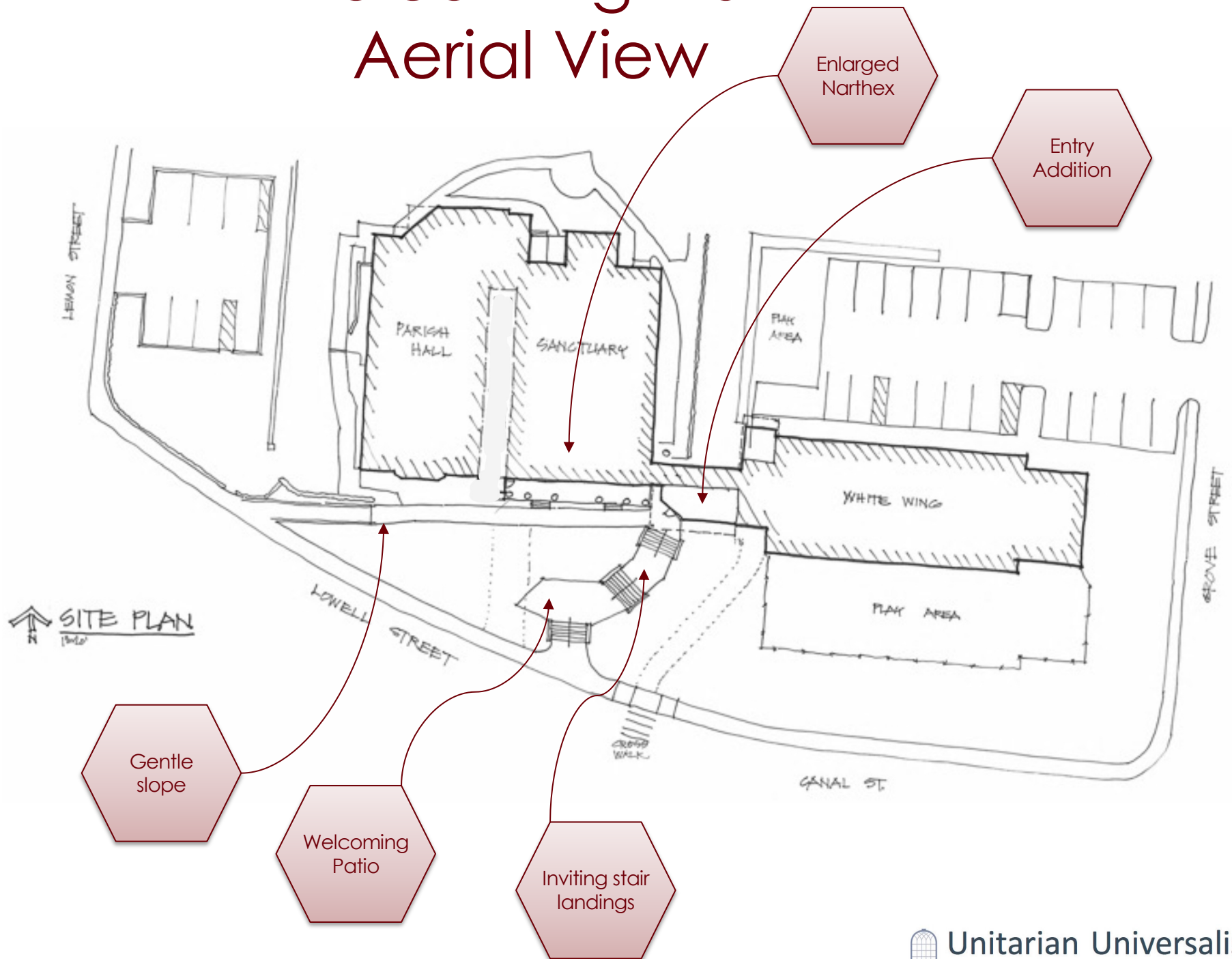

Welcoming Plan Detail View

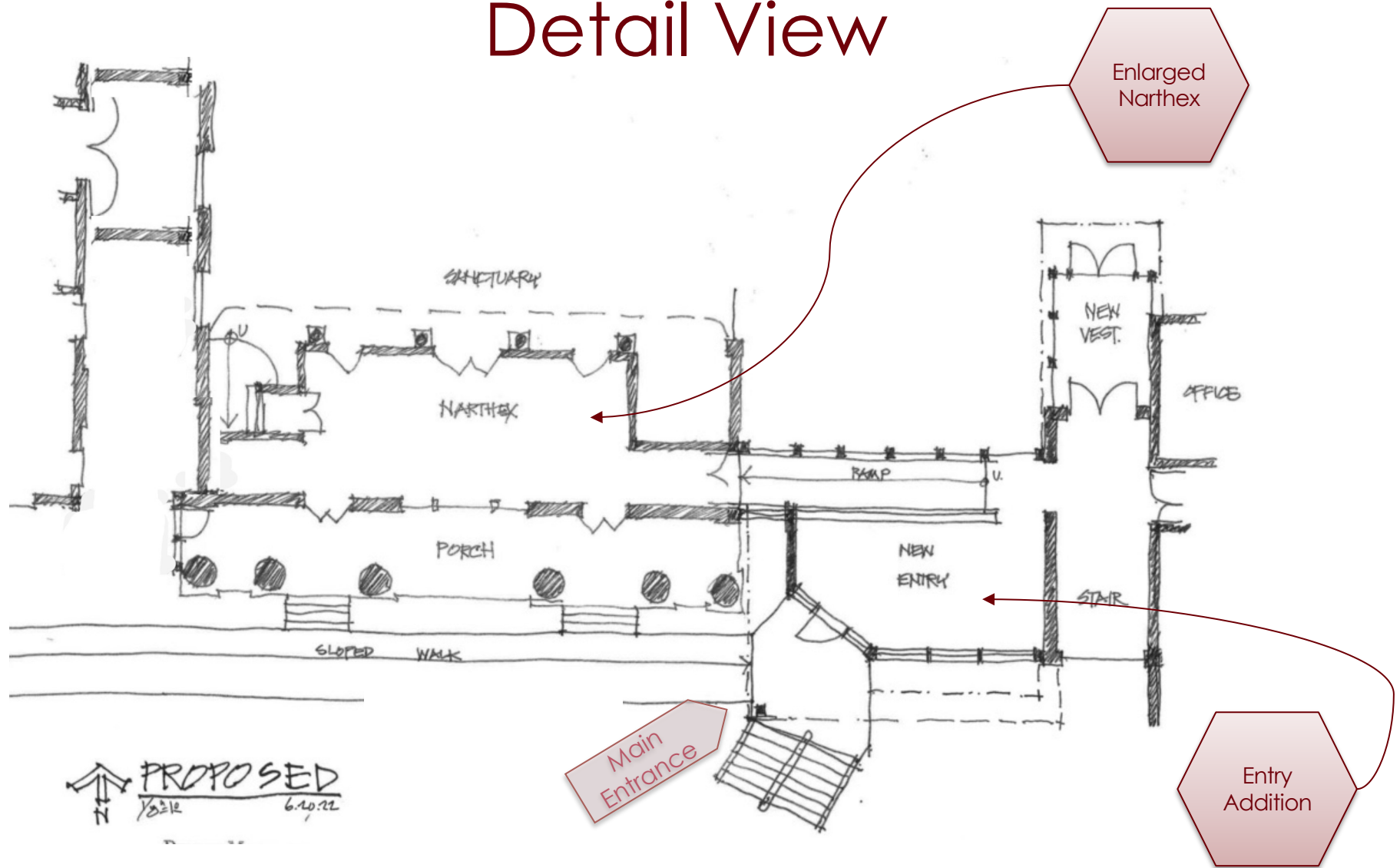

Welcoming Plan Narthex



View of Narthex entering at back of sanctuary

Welcoming Plan Entry

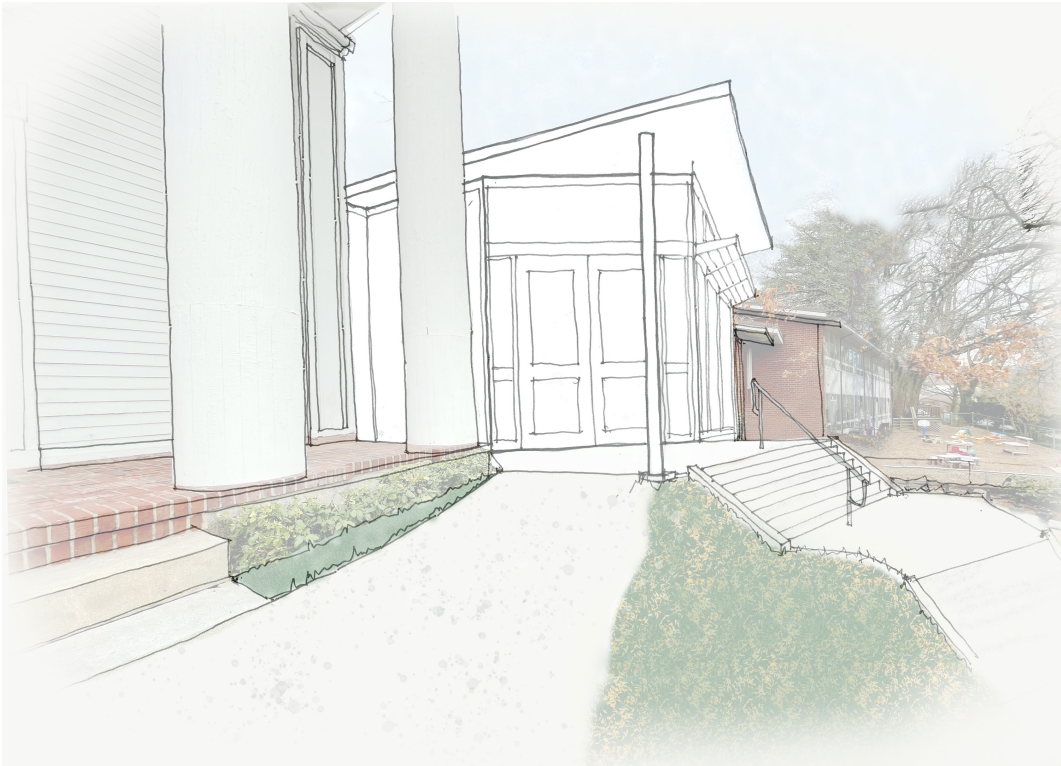

View of New Entry exterior

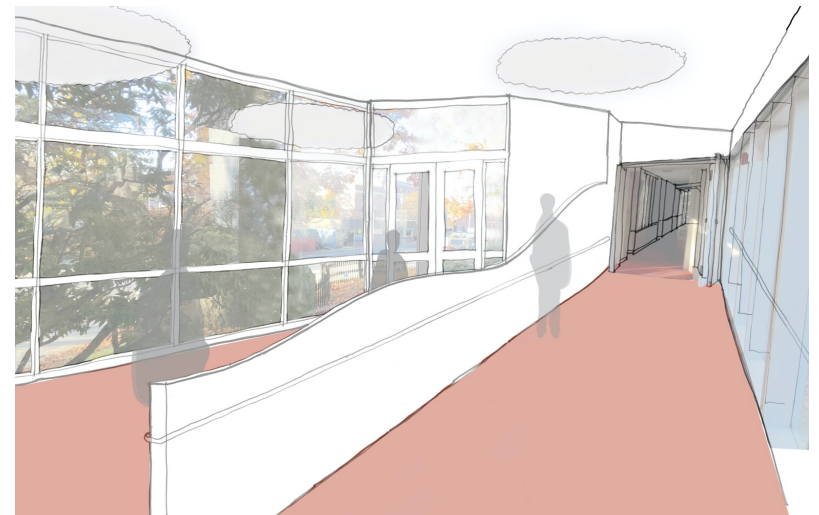

View of New Entry interior

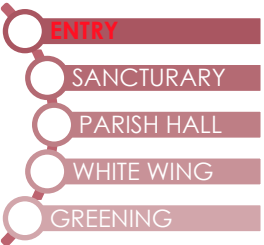

Building Our Vision Visionary Plan

- Sky lit connector
- Sanctuary Improvements
- Update the lighting, furnishings, and wall coverings of the Parish House and White Wing Buildings

- **Plus Welcoming Plan features**
 - New entry way to the church that is ADA accessible
 - Expanded Narthex

- **Plus Core Plan features**
 - New efficient Gas Boilers for Sanctuary and Parish House
 - Insulation in the walls and attic of the Sanctuary & Parish House
 - Add large glass panels on the inside of the Sanctuary windows to make them more energy efficient



Visionary Plan Overview

- **Sky Lit Connector**
 - Provide a single entrance, and help visitors find their way intuitively on the campus
 - **Navigate the Campus without disturbing its activities**
- **Sanctuary Improvements**
 - More useful for a greater range of events
- **Update** the lighting, furnishings, and wall coverings of the Parish House and White Wing Buildings

Note: Red color indicates new features in visionary plan

Visionary Plan External View

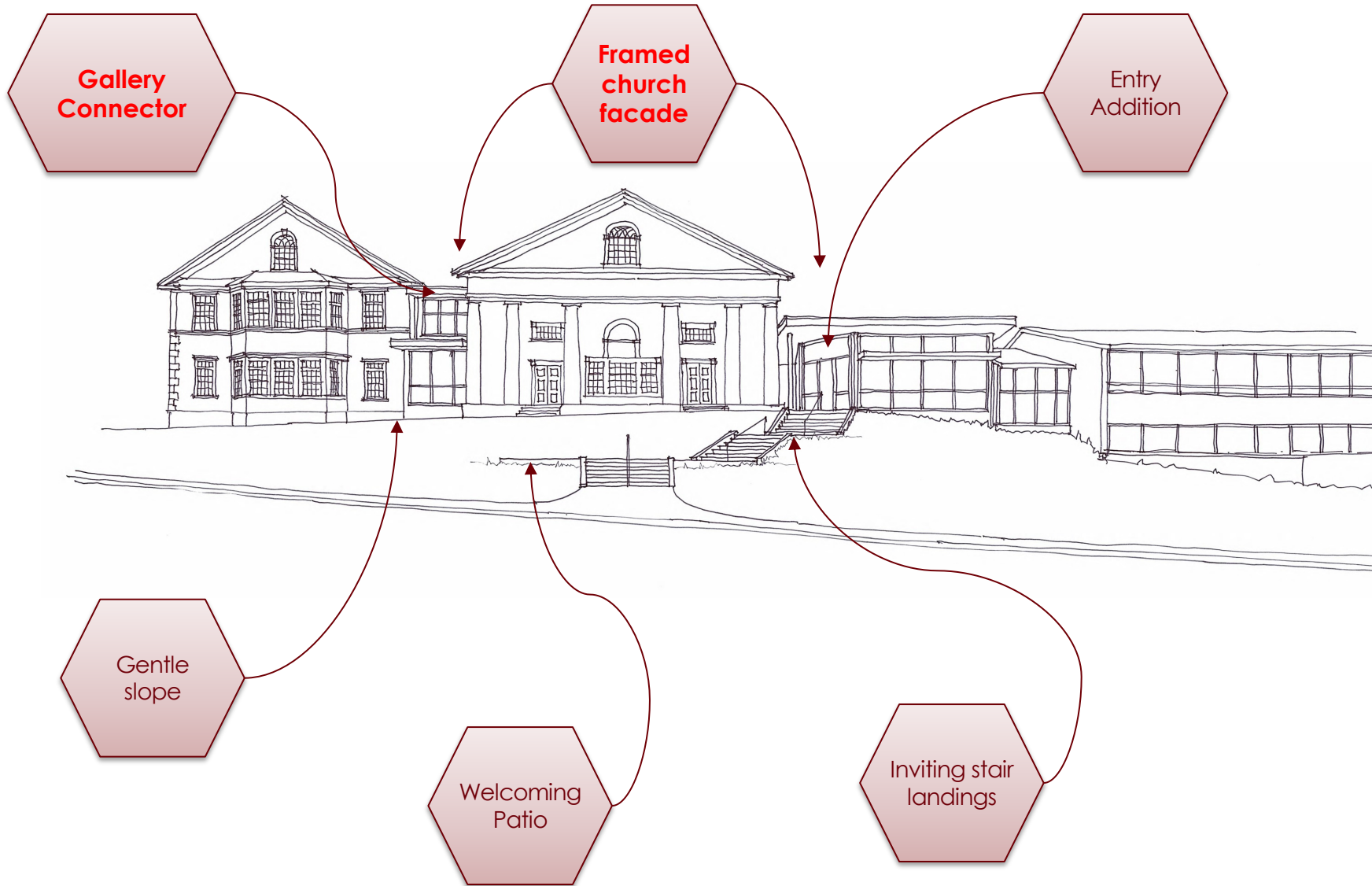

Note: Red color indicates new features in visionary plan

Visionary Plan Aerial View

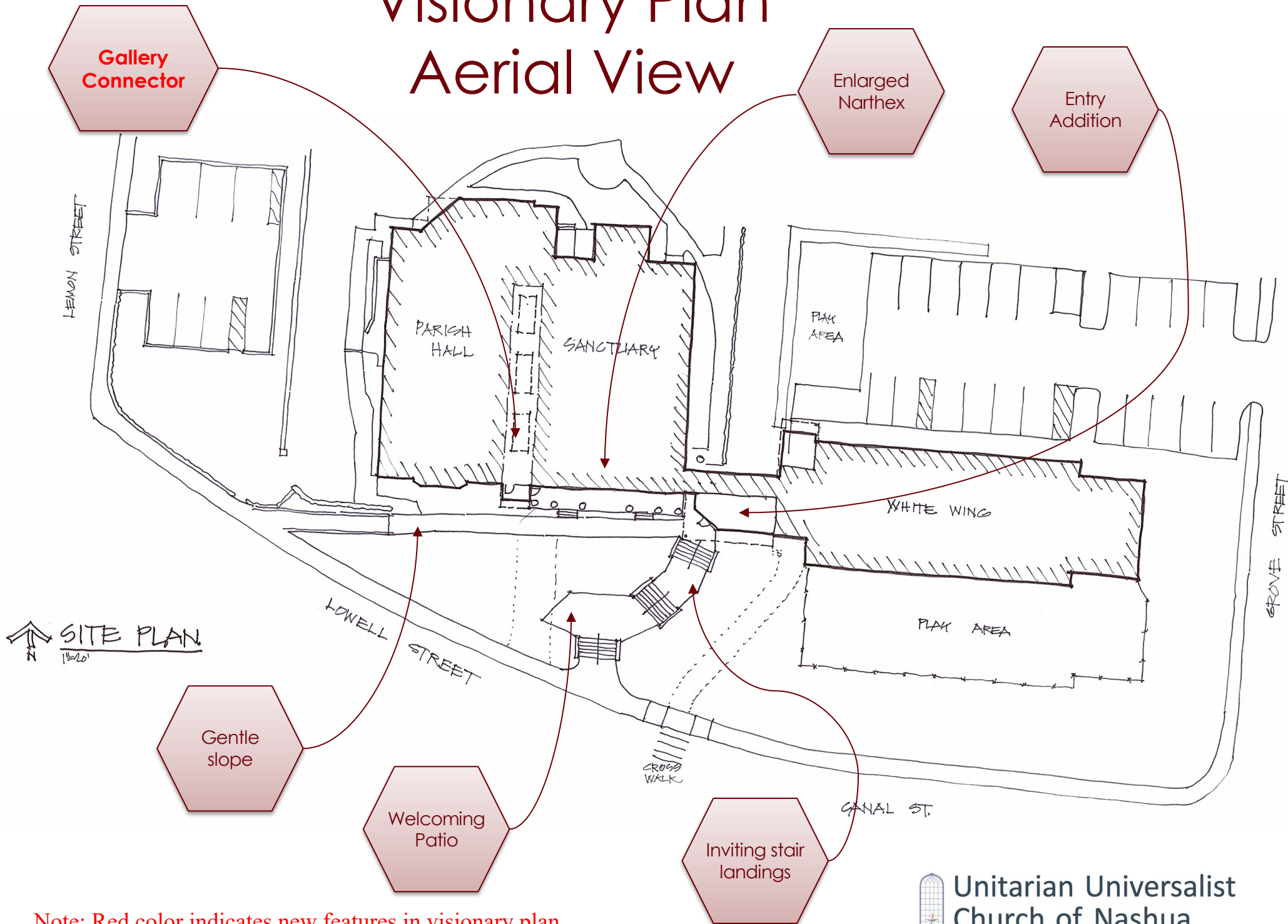

Note: Red color indicates new features in visionary plan

Visionary Plan Sky Lit Gallery Connector



View of Gallery Interior



Visionary Plan Sanctuary

- **Chancel accessibility** – No stair, no long ramp
- **Chancel flexibility** – Organ, choir, piano, pulpit,
- **Seating: Flexibility and Comfort** – while keeping the historical New England feel
- **No disruption** of the service
 - Can enter Parish House from Narthex without entering Sanctuary
- **Historic** New England feel



Visionary Plan Sanctuary



- Leveled Chancel area
- Flexible comfortable seating
- New HVAC
- Accessible Aisles
- Retained Pews

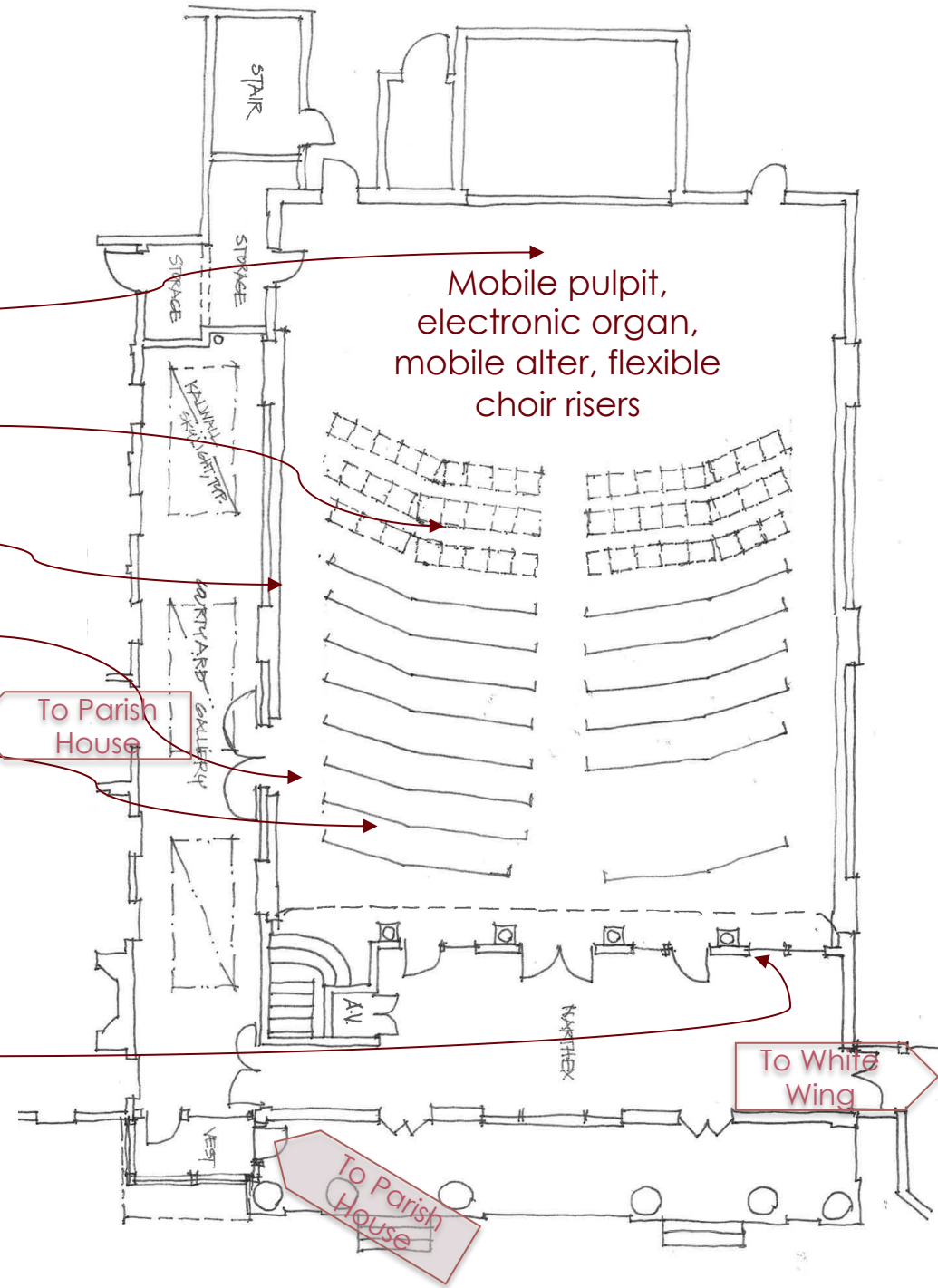

Mobile pulpit,
electronic organ,
mobile altar, flexible
choir risers

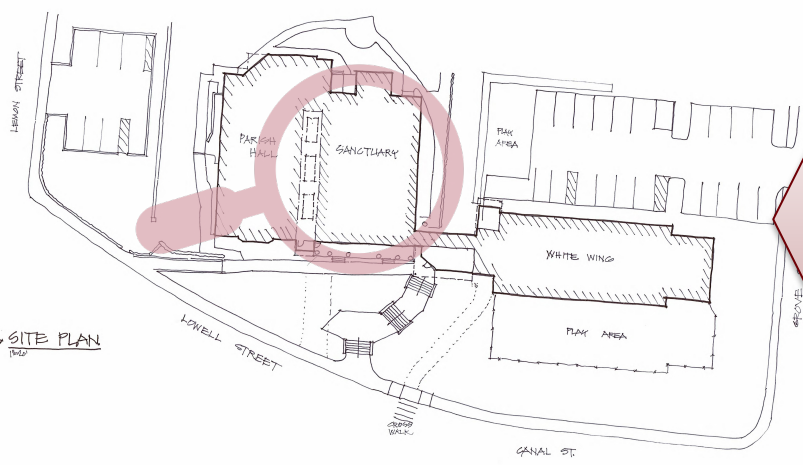

Enclosed
Narthex

To White Wing

To Parish House

Visionary Plan Sanctuary

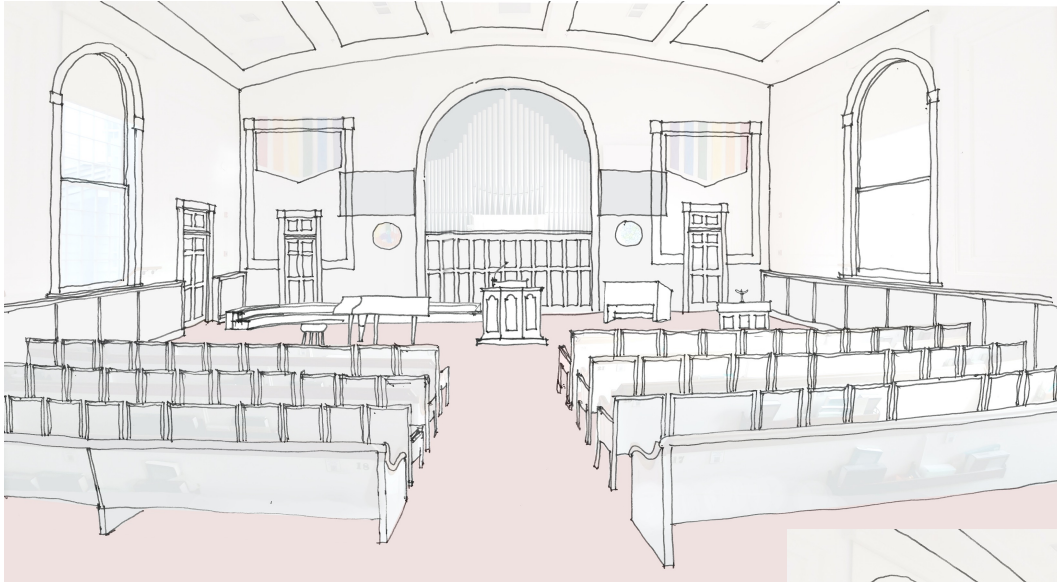

Sunday Service Configuration

Public Concert Configuration



Note: First several rows are configurable chairs, remainder are pews



Unitarian Universalist
Church of Nashua

Building Our Vision



**Gracious thanks to Dennis & Caroline
DENNIS MIRES, PA THE ARCHITECTS**

697 Union Street

Manchester, NH 03104

For providing the material for this presentation



Unitarian Universalist
Church of Nashua